



Traveling Aggies

A PROGRAM OF
The Association of Former Students



Exploring Galápagos: One Week Sailing the Islands

With an Optional Extension to Peru

NOVEMBER 7-16, 2025

ABOARD NATIONAL GEOGRAPHIC ENDEAVOUR II



SPECIAL OFFER: 10% GROUP SAVINGS



Howdy, Ags!

The collection of islands known as the Galápagos is, in the words of Charles Darwin, “a little world within itself.” Here, prehistoric-looking marine iguanas bask on stark volcanic landscapes, barking sea lions loll about on pristine white beaches, and magnificent frigatebirds nest in the silvery palo santo trees. Finches flit between tree branches and schools of golden rays swim among the intricate roots of mangrove stands.

We invite you to witness the iconic creatures and habitats of Galápagos for yourself on an incredible voyage aboard the *National Geographic Endeavour II*. Equipped with kayaks, stand-up paddleboards, a fleet of Zodiacs, and a custom-designed glass-bottom boat, this 52-cabin expedition ship is purpose-built to bring you unforgettable experiences. Paddle along rocky shores beside gliding sea turtles, snorkel with penguins, and hike among dancing blue-footed boobies. There will also be plenty of chances to spot marine life—like leaping dolphins and rays—from the comfort of our ship.

Our tour operator, Lindblad Expeditions-National Geographic, has spent decades exploring Galápagos and is well known for the exceptional travel experiences they offer in the archipelago. Their naturalists have a deep knowledge of island species and habitats that allows them to make the most of nature’s opportunities—which means you will enjoy adventure-filled days and amazing wildlife sightings. Many are also Galapagueños, providing an authentic connection to the region’s culture.

Make the most of your time and add an optional post-voyage land extension to Peru, exploring Machu Picchu, the Sacred Valley, Cusco, and Lima. We hope you will join us to discover these magical places.

To reserve your space, please return the reservation form, email groups@expeditions.com or call our group representative at Lindblad Expeditions at 833-985-1261.

Gig em!



Julie Scamardo
Manager of Traveling Aggies
The Association of Former Students

SPECIAL OFFER

Save 10% when traveling with the Traveling Aggies. See page 12 for details.

Discover the Magic of Galápagos

A Wilderness Like No Other

Few wildernesses are more iconic than Galápagos—the lava-sculpted realm that once played host to Charles Darwin and his living laboratory. Home to a menagerie of wild and wonderful creatures with no instinctive fear of humans, the archipelago’s pristine seas and shores still look much as they did when the legendary naturalist arrived nearly 200 years ago. Penguins welcome visitors while wizened marine iguanas sunbathe on volcanic rocks and giant tortoises roam through misty meadows. Discover these wild wonders and much more on an immersive adventure refined over decades of voyaging to these magical isles.

Actively Explore Every Day

Our Galápagos itinerary features daily activities for every skill level, with each excursion designed to immerse you in the Enchanted Isles. Snorkel with acrobatic sea lions, go on a photo walk to capture up-close images of blue-footed boobies, or take a ride in a glass-bottom boat—you can explore your way, every day.

We also reveal the wonders hidden beneath Galápagos waves through our in-depth undersea program. The voyage features an undersea specialist who documents the marine environment, gathering footage for daily Recaps in the lounge so that all guests can glimpse the fascinating sea creatures and their oceanic habitats.

Opposite page (clockwise from top): A blue-footed booby sitting on nest and two chicks; Galápagos flamingo; great blue heron takes flight in front of San Cristóbal Island, Galápagos National Park.





Get a New Perspective on Iconic Wonders

A Perfectly Appointed Expedition Ship

Equipped with expansive decks and custom tools, *National Geographic Endeavour II* is geared for adventure. Guests have access to kayaks, stand-up paddleboards, a glass-bottom boat, and dedicated snorkeling gear, and our nimble Zodiacs allow for exploration along the archipelago's hidden shores.



Superior amenities ensure discovery continues on board. Read up on Galápagos luminaries in the library before heading to the lounge for your nightly Recap. Or unwind in the fitness center or spa treatment room. You can also enjoy a taste of the archipelago at every meal through our pioneering farm-to-table food program.

Travel with a Veteran Team

Every member of our team—from our naturalists to our expedition leaders—is committed to ensuring you have an unforgettable experience. Many of our veteran guides are Galapagueños; in addition to sharing their extensive knowledge of island species and habitats, they offer an authentic connection to local culture.

A Lindblad Expeditions-National Geographic certified photo instructor also joins the voyage to assist travelers with everything from camera and smartphone settings to composition. Every guest, at every skill level, can stand side by side with top photographers, pick up tips, and return home with the photos of a lifetime.

Opposite page (clockwise from top): Guests ride a Zodiac from the National Geographic Endeavour II; photography expert Jonathan Kingston with guest, Santa Cruz Island; a Galápagos penguin at rest. This page: Galápagos marine iguanas rest on some rocks.

Voyage Itinerary

Explore the legendary Galápagos Islands aboard our comfortable 52-cabin expedition ship, well equipped for active exploration and meaningful encounters with wildlife.

DAY 1: Quito or Guayaquil, Ecuador

We meet you on arrival in Ecuador, either in Quito, Ecuador's capital city in the Andes, or in the coastal city of Guayaquil, for an included transfer to your convenient hotel for an overnight stay. Both cities are well-served by international carriers, and Galápagos flights start and end in Quito with a stop in Guayaquil. Guests in Guayaquil stay at the locally owned Hotel Oro Verde and have the choice of several hotels in Quito, including a convenient airport hotel.

DAY 2: Quito or Guayaquil/Galápagos

This morning, take a required flight to the Galápagos Islands (booked by Lindblad Expeditions at an additional cost) and board *National Geographic Endeavour II*. After lunch, we begin our exploration of the islands and their diverse wildlife. (B,L,D)

DAYS 3-8: Exploring the Galápagos

Our expedition includes visits to Santa Cruz and a careful selection of other diverse islands. Our itinerary offers an optimal balance of wildlife, landscapes, and experiences. All itineraries are subject to Galápagos National Park regulations. Here is a sample of islands we may visit during our expedition. (B,L,D Daily)

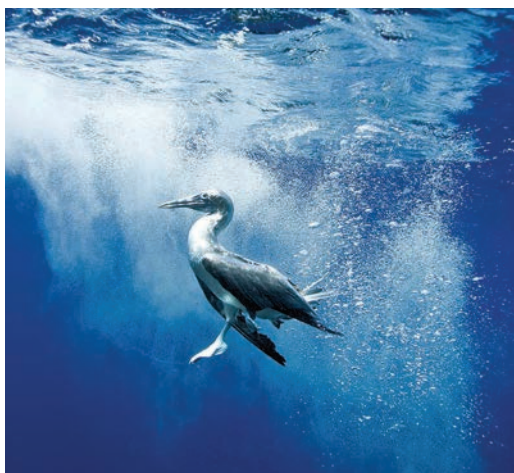

Española

Home to swallow-tailed gulls, Española mockingbirds, Nazca boobies and, seasonally, the world's only population of waved albatross at Punta Suarez.

Floreana

Follow a trail past a rose pink-tinted lagoon frequented by flamingos. Snorkel among sea lions and abundant fish, or cruise along Champion Islet by Zodiac. Visit the famous barrel at Post Office Bay.

Santa Cruz

Santa Cruz is not just the principal town in the islands, it is home to the Charles Darwin Research Station, where you learn about the science being done here. Visit the neighboring captive breeding program for

Galápagos giant tortoises being conducted by their partners in conservation, the Galápagos National Park Service. Later after lunch in the highlands, search for wild Galápagos giant tortoises in their native habitat. Continue on a second day exploring the north of the island at Cerro Dragon, the habitat of the colorful Santa Cruz land iguanas, brought back from the brink of extinction. Later take a Zodiac cruise or paddle a mangrove-lined lagoon.



Bartolomé

Walk to the top of Bartolomé's volcanic cone for a stunning view of Pinnacle Rock and the surrounding golden sand beaches. After the hike, immerse yourself among schools of multicolored reef fish. You may also have the opportunity to swim with Galápagos penguins. Visit Sombrero Chino, the nearby islet in the shape of a Chinese hat, where you can take a Zodiac ride along the Sullivan Bay lava flow, and may also kayak and paddleboard.

Genovesa

Sail into a flooded caldera, walk among swallow-tailed gulls, red-footed boobies, and Nazca boobies and keep a lookout for hunting short-eared owls. Ride Zodiacs, kayak along the caldera, and snorkel among large schools of parrot fish at this magical place.

DAY 9: Galápagos/Disembark/Quito or Guayaquil

Disembark this morning for a return flight to the mainland, where we transfer to Hotel Oro Verde in Guayaquil, and have several options in Quito, including a convenient airport hotel. The afternoon and evening are at your leisure. You may be able to take advantage of overnight flights home. (B)

DAY 10: Quito or Guayaquil

After breakfast, transfer to the airport and board flights home. (B)

OPTIONAL PRE-VOYAGE EXTENSION:

Tropical Andes & Colonial Quito • 6 Days • From \$3,050

Before your Galápagos adventure, discover the lesser-known wonders of mainland Ecuador on this six-day adventure in the Andes. Explore Quito, a UNESCO World Heritage site, from the comfort of historic Casa Gangotena on Plaza San Francisco. Then immerse yourself in the heart of the Ecuadorian Chocó, one of the world's top five biodiversity hotspots, at Mashpi Lodge.

Galápagos + an Extension to Machu Picchu & Peru's Land of the Inca

16 DAYS/15 NIGHTS—ABOARD NATIONAL GEOGRAPHIC ENDEAVOUR II + LAND EXCURSION



The mystical stone ruins of the Inca, Machu Picchu.

As magnificent as the Galápagos Islands are for wildlife, so is Peru from a cultural and archaeological perspective. Take advantage of your proximity to explore Peru's Sacred Valley of the Inca, majestic Machu Picchu, and the winding, colonial streets of Cusco. Gain insights from the historian Peter Frost.

DAYS 1-8: SEE THE GALÁPAGOS ITINERARY ON PAGES 6-7.

DAY 9: GALÁPAGOS/GUAYAQUIL/LIMA, PERU

Depart Galápagos this morning and fly to Lima, Peru via Guayaquil, arriving in the evening. Check-in at Belmond Miraflores Park, set on a green promenade overlooking the Pacific in fashionable Miraflores. (B)

DAY 10: LIMA

Explore World Heritage-designated colonial Lima this morning, where we stroll the Plaza Mayor and delight in a private welcome lunch with a special musical presentation at Casa Aliaga, one of the oldest houses in Lima. Then visit the extraordinary Larco Museum dedicated to pre-Columbian art. Return to our hotel with dinner on your own to sample local fare. (B,L)

DAY 11: LIMA/CUSCO/SACRED VALLEY

Board a short scenic flight to Cusco this morning, and continue to Moray—a visually stunning Inca site with dramatic agricultural terraces in the heart of the fabled and fertile Urubamba Valley. After lunch and an opportunity to experience a local market, check-in at Sol y Luna, an independently owned **Relais & Châteaux** property where we stay in individual casitas set in verdant gardens. Unwind with dinner at the hotel tonight. (B,L,D)

DAY 12: SACRED VALLEY

Spend the day exploring the archaeological sites and culture of the Sacred Valley in the company of historian Peter Frost (or a colleague), who has lived and worked in Peru for decades. He or a colleague joins us for a talk at our hotel and a visit to the massive Inca stone fortress of Ollantaytambo, set above a thriving Inca community. Lunch is at a working, family-owned hacienda, where we are treated to a show of Peruvian Paso horses, and National Geographic grantee Nilda Callañaupa, founder of El Centro de Textiles Tradicionales de Cusco, demonstrates Inca weaving traditions. (B,L,D)

DAY 13: SACRED VALLEY/MACHU PICCHU

Marvel at the dramatic scenery by train to Machu Picchu, the Inca royal retreat famously introduced to the world by Hiram Bingham in the April 1913 issue of *National Geographic* magazine. Check-in at the 31-room Belmond Sanctuary Lodge, adjacent to the UNESCO World Heritage site. Explore over two days in the company of your handpicked tour director and local guides. Lunch and dinner at the hotel. (B,L,D)

DAY 14: MACHU PICCHU/CUSCO

Awaken this morning overlooking Machu Picchu, where we have a full morning to explore with our guides or spend time in Machu Picchu Pueblo at the foot of the mountain. After lunch, return by train and bus to Cusco—UNESCO World Heritage site and a burgeoning cultural capital. Check-in at the Belmond Hotel Monasterio, in the heart of colonial Cusco, for two nights. (B,L,D)

DAY 15: CUSCO

Explore the magnificently ornate 17th-century cathedral, the sacred Inca Temple of the Sun, and other treasures of Cusco. Visit nearby Sacsayhuamán, with commanding views over the city. This afternoon is at leisure to discover Cusco. Dinner is on your own. (B,L)

DAY 16: CUSCO/LIMA

After breakfast, fly from Cusco to Lima, connecting to flights home. Depending on your flight schedule, optional rooms at the Wyndham Costa del Sol Lima Airport Hotel are available. (B)

PERU EXTENSION COST PER PERSON

DOUBLE: \$6,038 SINGLE: \$7,446

Cost Includes: Seven hotel nights; meals indicated; transfers if traveling on designated flights; sightseeing; portage; services of local guides and tour escort; tips to local guides, drivers, and tour escort; taxes and service charges. Not Included: Airfare; meals not indicated as included; alcoholic beverages; personal items.

Peruvian woman with llama.



National Geographic Endeavour II



This purpose-built expedition vessel sails the Galápagos year-round and embodies the style of travel we have refined over more than 50 years of exploration here. Evoking the feel of both a sumptuous hotel and a scientific research vessel, she features an open-air observation deck, exceptional views, and an impressive roster of exploration tools—all of which foster up-close and personal exploration.

Capacity

52 outside cabins and suites accommodating 96 guests.

Registry

Ecuador.

Overall Length

236 feet.

Public Areas

Forward lounge and bar for presentations and gatherings, restaurant, large library with Mac computer kiosks, open-air observation deck, underwater gear area and efficient Zodiac boarding platform, and open Bridge, where guests are welcome to learn about navigation from the captain and officers.

Meals

Served in single, unassigned seating in a sociable, informal atmosphere. Menu emphasizes Ecuadorian flair.



The casual dining room.

Accommodations

Cabins and suites face outside with large windows and feature twin beds that convert to a queen. With private facilities, climate control, nightstands, desk, and storage. Seven sets of cabins with a connecting door and nine solo cabins.



Comfortable Category 4 cabin.

Expedition Equipment

Zodiacs, glass-bottom boat, kayaks, stand-up paddleboards, snorkel gear including wetsuits for adults and children, video microscope, and underwater video camera.

Staff & Crew

Every member of our staff is committed to ensuring our guests have an unforgettable experience. Many of our veteran guides and naturalists are locally based in your destination and have worked with us for decades. A full-time doctor, undersea specialist, professional photographer and Lindblad Expeditions-National Geographic certified photo instructor are on board, and with a low staff-to-guest ratio, you can hear different perspectives and gain new insights every day.

Special Features

National Geographic Global Explorers family program, snorkel instruction, Wi-Fi access, laundry service, and Global Gallery.

Wellness

LEXspa and fitness center, exercise classes, and wellness specialist.

Sustainability

From our carbon neutrality initiatives to the locally sourced food we serve on board, our expeditions are designed around the well-being of our world. Travel with peace of mind, knowing that green practices are embedded in our operations and that each voyage gives back to the places we explore.

Ship Deck Plan & Pricing

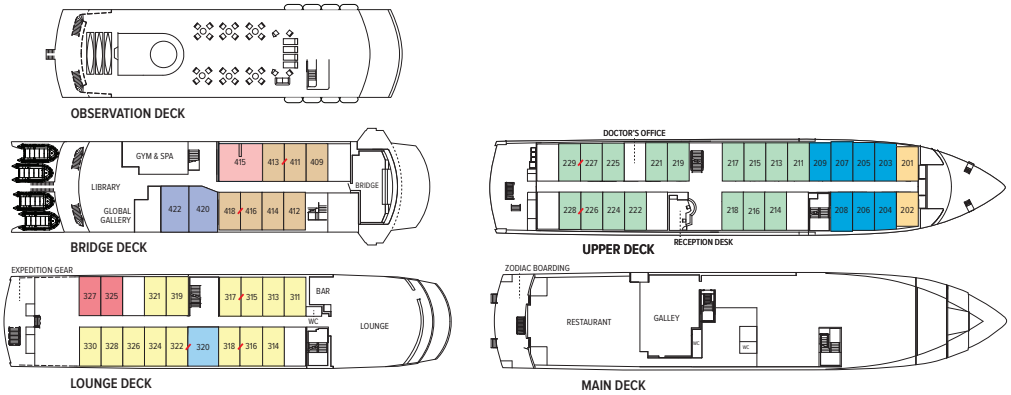

↗ indicates adjoining cabins

Voyage Dates

November 7-16, 2025

Advance Payment Details

15% of the cabin fare, per person

With compliments, your bar tab and Wi-Fi are included.		
Category	Cabin Numbers	10% SAVINGS
Category 1	Upper Deck, Forward #201, 202	\$6,538 \$5,885
Category 2	Upper Deck #211, 213-219, 221, 222, 224-229; See deck plan for adjoining cabins.	\$7,847 \$7,063
Category 3	Lounge Deck #311, 313-319, 321, 322, 324, 326, 328, 330; See deck plan for adjoining cabins.	\$8,722 \$7,850
Category 4	Bridge Deck #409, 411-414, 416, 418; See deck plan for adjoining cabins.	\$9,800 \$8,820
Suite A*	Lounge Deck, mid-ship #320—with two windows, larger bath, armchair. Connecting door to #322.	\$11,767 \$10,591
Suite B*	Bridge Deck, mid-ship #420, 422—with two floor-to-ceiling windows, larger bath, convertible sofa for a third person.	\$12,698 \$11,429
Suite C*	Bridge Deck, mid-ship #415—with two large windows, larger bath, separate sitting area with convertible sofa for a third person and armchairs, largest cabin on ship.	\$13,356 \$12,021
Category 2 Solo	Upper Deck #203-209	\$9,807 \$8,827
Category 3 Solo	Lounge Deck #325, 327	\$10,899 \$9,810

***Suite Exclusives:** The suites on our ships are your elegant retreat at sea, featuring spacious living areas and incredible ocean views. Now, booking one of these beautifully appointed accommodations comes with even more benefits. Our new Suite Exclusives package gives guests staying in eligible cabins access to an array of amenities designed to enhance your on-board experience, including priority booking for spa treatments, complimentary laundry, and other exclusive perks.

Note: All cabins and suites feature the option of two singles or a queen bed, plus large window(s), desk, chair, and closet.

Connecting cabins: #226/228, 227/229, 315/317, 316/318, 320/322, 411/413, 416/418

Triple Occupancy: #224, 225, 326, 328 with fold-down third berth, Suites B and C with convertible sofa bed. Third person rates are one-half per person double occupancy rate.

Shared Accommodations: Shares can be arranged at the double occupancy rate in Categories 1 and 2.

INCLUSIVE PRICING

- All accommodations aboard ship
- Excursions and hotels, as indicated in the itinerary
- Airport transfers for all arrivals and departures
- All meals as indicated in the itinerary, both aboard and onshore. Meals and hors d'oeuvres are inspired by regional cuisine and locally sourced where possible
- 24-hour access to snacks, premium coffees and teas, non-alcoholic beverages, and filtered water
- Beer, wine, cocktails, and spirits. We are also pleased to offer a selection of super premium wines and liquors, available for purchase
- Selection of exploration tools curated to the Galápagos, including Zodiacs, a glass-bottom boat, stand-up paddleboards, kayaks, snorkeling equipment (including wetsuits, masks, and fins), and other gear
- The guidance and company of our leading expedition staff
- Presentations by the expedition staff
- Complimentary reusable water bottle
- The services of the ship's physician
- 24-hour access to lounges, observation decks, library, and other shared spaces
- Morning stretch classes and 24-hour access to the fitness center
- Assistance by the onboard photo instructor
- Special access permits, park and site entrance fees, and port taxes
- Basic Wi-Fi, with the option to upgrade

TAKE ADVANTAGE OF OUR SPECIAL OFFERS

SPECIAL 10% GROUP SAVINGS: Save 10% on the cabin fare (as indicated) when traveling with Texas A&M/The Association of Former Students. Valid on this departure date of *Exploring Galápagos: One Week Sailing the Islands*, for new bookings only, subject to availability, may not be combined with other offers, and is not applicable on airfare or extensions. Call for details. .

CELEBRATE LIFE'S MILESTONES: Celebrate a milestone with a group of eight or more and enjoy a special amenity package including: 5% savings on voyage fares, custom group photo, \$150 shipboard credit for the group, and other special gifts. Milestone celebration to be communicated at time of booking. Valid for new bookings only, subject to availability, not applicable on airfare or extensions, and may not be combined with other offers.

BRING THE KIDS: Sharing an expedition with your kids or grandkids is a life-enhancing experience. Take \$500 off the double occupancy price for each person under 18. Not applicable on extensions or airfare.

TERMS AND CONDITIONS

Prices quoted in this brochure are per person based on double occupancy in USD. Prices quoted are subject to change and availability at time of booking. Under normal conditions the total expedition price is guaranteed at the time advanced payment is made. However, our expedition pricing is determined far in advance of initial departure on the basis of then-existing projections of fuel and other costs. In the event of increases in those costs, including but not limited to increases in the price of fuel, currency fluctuations, increases in government taxes or levies, or increased security costs, we reserve the right to adjust the price of your expedition or add a surcharge to cover such unexpected increases. We will always provide an explanation of the reason for increase in costs.

COST INCLUDES: All amenities listed in inclusive pricing above. Unused services or items included in this program are non-refundable.

NOT INCLUDED: Airfare, both international and internal; pre- and post-expedition extensions; additional hotel nights; meals not indicated; private transfers; travel protection plan; passport, visa, and immigration fees; crew gratuities; items of a personal nature such as laundry, certain super premium wines and liquors, spa treatments, enhanced and premium Wi-Fi plans, and phone services.

AIRFARE: Airfare, both international and internal, is an additional cost. International and internal Ecuador tickets must be issued separately. Internal tickets must be booked by Lindblad Expeditions. Lindblad Expeditions will assist in making your international air arrangements for a \$50 per person service fee.

RESERVATIONS: To confirm your place, an advance payment of 15% of the cabin fare, per person is required and is payable by Visa, MasterCard, American Express, Discover, or check. Receipt of advance payment indicates your acceptance of the terms and conditions.

FINAL PAYMENT: Due no later than 120 days prior to departure. Lindblad Expeditions reserves the right to cancel your reservation if payment has not been received by final payment due date.

TRAVEL PROTECTION PLAN: A travel protection plan is available at an extra cost. Information will be sent to you upon registration.

ENTRY AND VISA REQUIREMENTS: Guests are advised to verify travel documents (passport/transit visa/entry visa) for the country(s) through which they are transiting and/or entering. Reliable and most current information regarding international travel can be found by contacting the consulate/embassy of the country(s) you are visiting or transiting through. We will not be responsible if you are denied entry or transit into a country if you are unable to provide valid documents as per the country's requirement.

RESPONSIBILITY AND OTHER TERMS & CONDITIONS: Certain other provisions concerning, among other things, limitations of Lindblad Expeditions' and National Geographic Expeditions' (a division of National Geographic Partners, LLC) liability for loss of property, injury, illness, or death during the voyage will be provided to all guests on the ship's ticket sent prior to departure or upon request. By registering for a trip, the guest agrees to all such terms and conditions.

CANCELLATION FEE POLICY (PER PERSON)

120 or more days prior to expedition start: **No penalty:** Advance Payment will be credited toward your next expedition**

119-90 days prior to expedition start: **50% of trip cost*****

89-0 days prior to expedition start: **100% of trip cost*****

**Advance payments will be credited in the form of a Lindblad Expeditions Travel Certificate, valid for 12 months from the date of cancellation, and which may only be applied towards final payment on any future booking.

***Trip cost is total price paid including extensions, charter airfare and other additional services.

We strongly recommend that you purchase a travel protection plan.

Photo Credits: Ralph Lee Hopkins, David Vargas, David Spiegel, Sven-Olof Lindblad, Michael S. Nolan, Kyle Furey, SuperStock, and Shutterstock.

No funds donated to The Association of Former Students or to Texas A&M University have been used in the production or mailing of this travel brochure; all such costs are covered by the tour supplier.

Reservation Form



Contact Information

Please send reservation to:
Lindblad Expeditions
96 Morton Street
New York, NY 10014
Ph: (833) 985-1261
Fax: (646) 390-2050
Email: groups@expeditions.com

Exploring Galápagos: One Week Sailing the Islands + optional extension to Peru

ABOARD NATIONAL GEOGRAPHIC ENDEAVOUR II
GALÁPAGOS: NOVEMBER 7-16, 2025
GALÁPAGOS + PERU: NOVEMBER 7-22, 2025

Passenger Information

Please reserve ____ place(s) on Galápagos Galápagos + Peru

Guest 1: _____
(Name as it appears on passport)

Date of Birth: _____ M/F: _____

Guest 2: _____
(Name as it appears on passport)

Date of Birth: _____ M/F: _____

Street Address: _____

City: _____ State: _____ ZIP: _____

Home Phone: _____ Cell Phone: _____

Business Phone: _____ Fax: _____

Email: _____

Accommodations: Double Single Twin share with a friend
 Share with roommate assigned by tour operator.

Please indicate choice of cabin category in order of preference:

1st choice: _____ 2nd choice: _____

Planned arrival/departure city: Quito Guayaquil

Please send detailed information about the **Tropical Andes & Colonial Quito** pre-voyage extension.

Advance Payment Information: 15% of the cabin fare, per person

If paying by check, please make payable to: **Lindblad Maritime Enterprises, Ltd.**
Enclosed is my advance payment of \$ _____

If paying by credit card, we will contact you to finalize your booking and collect payment information.

Exploring Galápagos: One Week Sailing the Islands

Expedition Highlights

- Walk among incredible wildlife unfazed by your presence, from giant tortoises and blue-footed boobies to marine iguanas and Sally Lightfoot crabs.
- Travel with our expert team of local naturalists and a photo instructor.
- Experience the waters of the Galápagos by kayak, glass-bottom boat, Zodiac, or paddleboard.
- Snorkel amid shimmering fish, sea turtles, penguins, and playful sea lions.
- On an optional post-voyage extension to Peru, explore three UNESCO World Heritage sites: Lima, Cusco, and Machu Picchu.
- With the National Geographic Global Explorers program, kids and teens can learn about and engage with the region through immersive, hands-on activities.

100% CARBON NEUTRAL AND COMMITTED TO BEING SINGLE-USE PLASTIC FREE

We have chosen Lindblad Expeditions because they care deeply about the planet and see travel as a powerful force for good.



Printed on 100% recycled content paper with soy-based inks. We recommend that you pass this along for others to enjoy or recycle.



Traveling Aggies in Galápagos.



Traveling Aggies

A PROGRAM OF
The Association of Former Students



The Association of Former Students
Texas A&M University
505 George Bush Drive
College Station, TX 77840

PRSRT STD
U.S. POSTAGE
PAID
LINDBLAD
EXPEDITIONS

GRP-TEXA&M-GALA25