



The Association
OF FORMER STUDENTS®
TEXAS A&M UNIVERSITY®

Traveling Aggies

FEB. 22 - MAR. 1, 2017

Special Former Student Rate

SAVE MORE THAN \$800

per couple

The Galapagos Islands

8 DAYS OF WONDER
& AMAZEMENT

** Think biology class - with deck chairs **

Howdy, Ags!

Join fellow alumni and friends as we explore the Galapagos Islands. Designated the first UNESCO World Heritage Site in 1978, the Galapagos Islands have been described as a “unique living museum and showcase of evolution” and are home to a fascinating array of wildlife inhabiting an unspoiled ecosystem, living in harmony with their human visitors.

This exciting journey features a day of guided touring in Quito, in addition to a cruise through the archipelago with unparalleled access to endemic species. Expert naturalists guide you through the wonders of this national park, whale sanctuary, and marine reserve.

Accommodations for this adventure are aboard the *Isabela II*, an intimate, 40-guest vessel with spacious cabins, local cuisine, and a staff dedicated to ensuring both your comfort and maximum enjoyment of this truly extraordinary destination and its diverse inhabitants.

Stateroom availability is limited. For special Traveling Aggies savings of more than \$800 per couple (family and friends are also eligible), reserve today online at <http://texas-am.orbridge.com>, by phone at (800) 633-7514 or by returning the enclosed reservation form.

Gig 'em,

Jennifer Bohac

Jennifer Bohac '87, Ph.D.

Director of Travel Programs

No funds donated to The Association of Former Students or to Texas A&M University have been used in the production or mailing of this travel brochure; all such costs are covered by the tour supplier.

Free Expedition Library

AN EARLY RESERVATION BONUS

Reserve your space by **July 11, 2016**, and receive the **FREE** Orbridge Expedition Library we've assembled for this program.

This exclusive gift is to thank you for joining us early. Guests who reserve after the specified date may purchase libraries. Call for details.





Discover the Galapagos

—intriguing islands of limitless natural wonders



Feel the thrill of encountering the flora and fauna that famously inspired Darwin—and in his footsteps, generations of nature lovers.



"The love for all living creatures is the most noble attribute of man."

—Charles Darwin



This archipelago, from which Darwin conceived his theory of evolution by natural selection, is one of the richest marine ecosystems in the world. With fascinating wildlife that exists from the ocean floor to the skies above the sea, discover for yourself the captivating diversity that inhabits these remarkable islands.

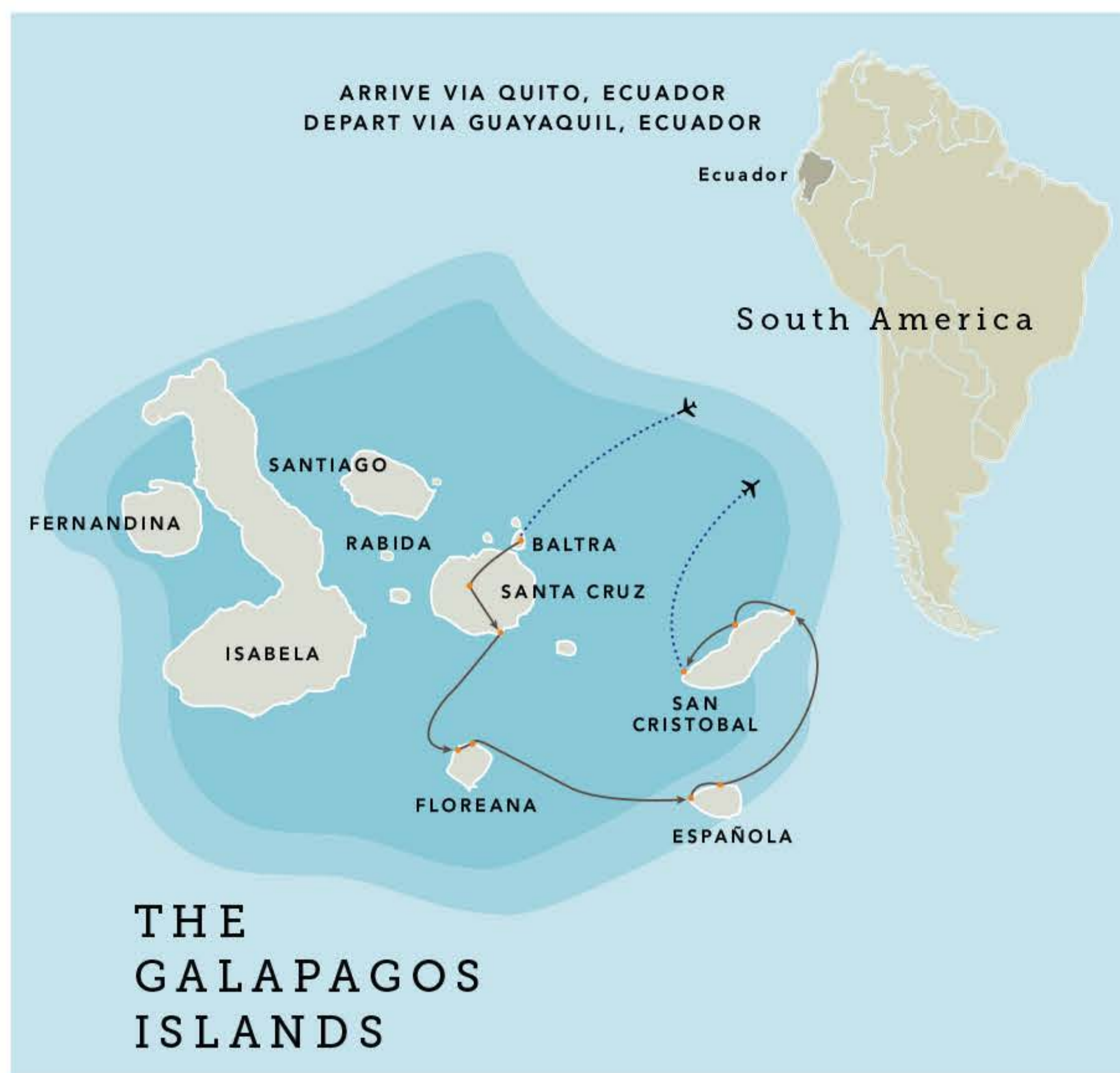

Your 8-Day Itinerary*

Day 1: *En route / arrive Quito, Ecuador*
Overnight: Hilton Colon, Quito

Day 2: Quito (B,L)
Guided walking tour of Old Town, market shopping, Jesuit church of La Compañía, Casa del Alabado Archaeological Museum
Overnight: Hilton Colon – Quito

Day 3: Quito / Flight to Baltra / Santa Cruz – Embarkation (B,L,D)
Giant tortoises in Santa Cruz Highlands, Puerto Ayora, welcome dinner on board
Overnight: *Isabela II*

Day 4: Floreana (B,L,D)
Historic Post Office Barrel, snorkeling or kayaking, Punta Cormorant beach stroll, green sea turtle nests
Overnight: *Isabela II*

Day 5: Española (B,L,D)
Punta Suárez hike, Gardner Bay, sea lion colony, glass-bottom boat ride
Overnight: *Isabela II*

Day 6: San Cristóbal (B,L,D)
Wildlife viewing at Punta Pitt, panga ride along the shores of Cerro Brujo, snorkeling or kayaking
Overnight: *Isabela II*

Day 7: San Cristóbal – Disembarkation / Flight to Guayaquil (B,L aloft)
Overnight: Wyndham Hotel – Guayaquil

Day 8: Guayaquil / Depart for U.S. (B)

Optional Extension: Days 8-13 in Machu Picchu, Cusco & the Sacred Valley

Activity Level: Guests should be sure-footed on stairs and able to walk at least one mile on rocky, volcanic, and uneven ground, as the nature treks can be on irregular and elevated terrain. Guests should also be comfortable managing beach landings and boarding small vessels, both from shore and the deck of *Isabela II*.

Max elevation: 9,350 ft. in Quito, Ecuador

Program Highlights

- Appreciate the diversity of life first-hand while observing endemic species such as the flightless cormorant, the Galapagos penguin, blue-footed boobies, giant tortoises, marine and land iguanas, and the famous “Darwin’s finches.”
- Swim with sea lions, and snorkel among colorful tropical fish and sea turtles.
- Discover amazing aquatic wildlife as you observe through a glass-bottom boat in the clear waters of the world’s second largest marine reserve.
- Explore remote coralline beaches and secluded inlets, such as Gardner Bay—where sea lions lounge and Española mockingbirds sing.
- Visit dramatic and historic places, including the lush highlands of Santa Cruz Island, the perfect habitat for the Galapagos Giant Tortoise, and Cerro Brujo, one of the first sites visited by Charles Darwin.
- **What’s included:** breakfast each morning and all on-board meals, including a welcome dinner; all excursions and presentations; airport transfers for guests arriving and departing during the suggested times; and internal airfare between Quito, the Galapagos Islands, and Guayaquil.

*Subject to change.



Isabela II

The 40-guest capacity of *Isabela II* provides 20 staterooms with spacious, comfortable accommodations and *en suite* facilities.

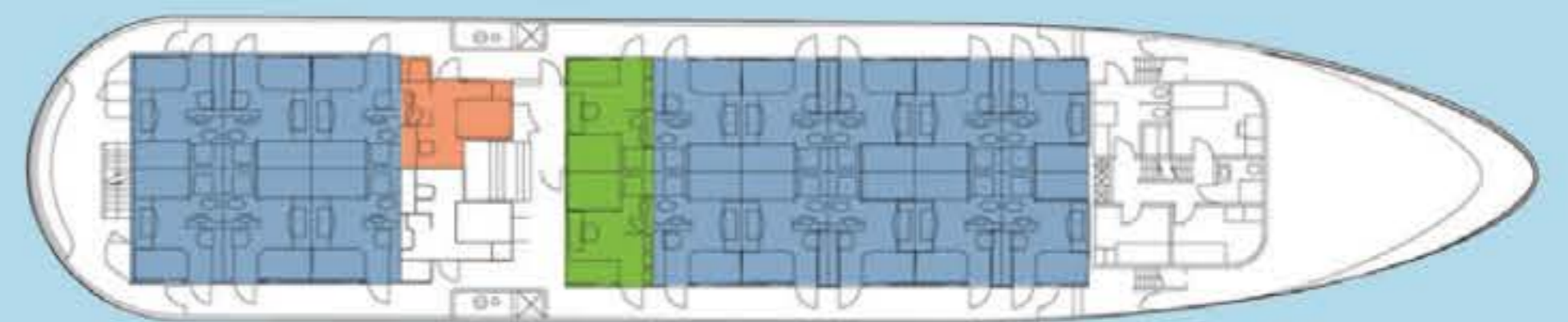

Cabin deck

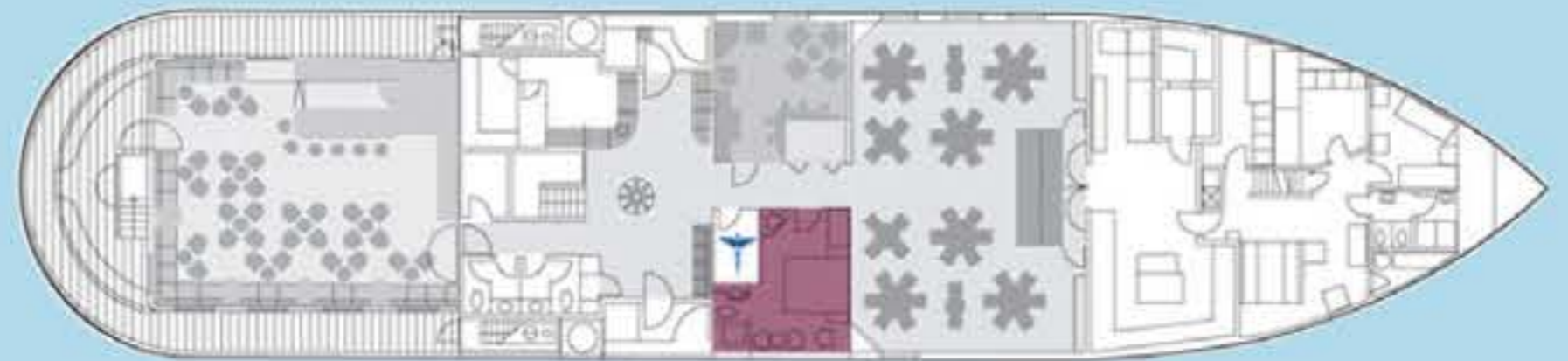

Main deck



Standard

Full-size bed, view window, private bathroom with shower. 128 sq. ft.



Classic Twin

Two twin beds, view window, private bathroom with shower. 139 sq. ft.



Classic Double

Full-size bed, view window, daybed, private bathroom with shower. 139 sq. ft.



Master Suite

Queen bed, view window, wardrobe, private bathroom with shower. 170 sq. ft.

HILTON COLON – QUITO

On the first two evenings, you will stay at the Hilton Colon. This elegant hotel is located in the city center's bustling Avenida Amazonas, and is a 10-minute walk to Quito's Spanish Colonial Old Town, a UNESCO World Heritage Site.



WYNDHAM HOTEL – GUAYAQUIL

Conveniently located just 3 miles from José Joaquín de Olmedo airport, this property offers deluxe accommodations for the last night of the program. Nearby are museums, gardens, shopping, and restaurants of the Malecón 2000, the boardwalk overlooking the Guayas River.



Your Expedition Leader

Viewing the Galapagos Islands alongside an Orbridge Expedition Leader is a special experience. While observing wildlife, your Expedition Leader will offer expert descriptions of methods of survival and behaviors. Together on skiff rides, nature walks, and aboard the *Isabela II*, you will gain understanding of the endangered species who inhabit the waters and land of the archipelago.



Orbridge



Optional Extension

Machu Picchu, Cusco, & the Sacred Valley

Travel to the mist-shrouded citadel of the Incas on this deluxe extension to Machu Picchu, Cusco, & the Sacred Valley.

Extension Itinerary*

- Day 8:** Guayaquil / Overnight Lima, Peru
Morning at leisure, *en route* via air to Lima
Overnight: Wyndham Costa del Sol – Lima
- Day 9:** Lima / Cusco / Sacred Valley (B,L,D)
En route via air to Cusco, explore the colorful and lively markets of Pisac
Overnight: Sonesta Posadas del Inca Yucay
- Day 10:** Sacred Valley / Machu Picchu (B,L,D)
Stroll Ollantaytambo, scenic Vistadome train to Machu Picchu, guided tour of “The Lost City of the Incas”
Overnight: Inkaterra Machu Picchu Pueblo Hotel
- Day 11:** Machu Picchu / Sacred Valley / Cusco (B,L,D)
Morning guided tour with time to hike at your own pace, Vistadome train to Cusco, afternoon at leisure
Overnight: Aranwa Boutique Hotel – Cusco
- Day 12:** Cusco / Saqsayhuaman / San Blas / Villa Tipón (B,L,D)
Walk through Cusco, Qorikancha Sun Temple, special farewell dinner
Overnight: Aranwa Boutique Hotel – Cusco
- Day 13:** Cusco / Lima / Depart for U.S. (B,L)
Return via air to Lima, traditional Peruvian fare, return to the U.S.
Day Room: Casa Andina Select Miraflores – Lima

Extension Highlights

- Seek out ancient temples and sites dotting the Sacred Valley and Cusco, each a vestige of pre-Columbian history that offers an in-depth understanding of the Incan empire.
- Visit Ollantaytambo, where Inca descendants continue to inhabit the largely unchanged homes of their ancestors.
- Experience the magic of a sunset on the “top of the world,” a traditional Peruvian lunch hosted by a local family, and an Andean Shamanic healing ceremony.
- **What’s included:** 5 nights choice accommodations; meals including 5 breakfasts, 5 lunches, and 4 dinners; flight between Lima and Cusco on Days 9 and 13; fully guided tours and field presentations from local experts; all ground excursion transportation, including Vistadome train through the Urubamba Valley; gratuities to guides, drivers, and waiters for included meals; and airport transfers, including portage, for guests arriving and departing during the suggested times.

Max elevation: 11,200 ft. in Cusco, Peru



Sonesta Posadas del Inca Yucay



Inkaterra Machu Picchu



Aranwa Cusco

Early Reservation Bonus:

.....
See reverse for details.

FREE ORBRIDGE 
EXPEDITION LIBRARY

The Galapagos Islands

FEBRUARY 22 - MARCH 1, 2017

Machu Picchu Extension: March 1-6, 2017

- Option 1:** Reserve online now at <http://texas-am.orbridge.com> or call (800) 633-7514.
- Option 2:** Secure your reservation with a deposit charged to the credit card below, or with an enclosed check payable to: Orbridge, LLC.

Standard Rate:	Special Rate:	
from	from	
\$4,399	\$3,995*	
Machu Picchu Extension		
Category	Standard Rate	Special Rate*
Standard	\$3,699	\$3,295
Deluxe	\$4,099	\$3,695
Single	\$5,099	\$4,695
Airfare between main program and extension is an additional \$690 per person.		

Guest Information:

Guest #1 (as printed on passport): _____ Class Year _____

Guest #2 (as printed on passport): _____ Class Year _____

Address: _____

City: _____ State: _____ Zip: _____

Email: _____ Phone: _____ Alt. Phone: _____

Category Preference: 1st choice _____ 2nd choice _____

Deposit:

(#) _____ guests joining program (\$850/person) +

(#) _____ guests joining extension (\$500/person) = **Total deposit: \$** _____

Extension Category (choose one): Standard Deluxe Single

Deposit Payment:

Check enclosed Online Check/ACH MasterCard/Visa American Express Discover

Card #: _____ Exp. date: _____ CW: _____

Name (as printed on card): _____

Billing address (if different from above): _____

City: _____ State: _____ Zip: _____

I/we have read, understand, and agree to the full Terms & Conditions at <http://terms.orbridge.com> and detailed in program documents; and that Orbridge LLC is authorized to charge my credit card above and/or take my/our deposit for this program.

Signature: _____ Date: _____

Mail or fax reservation form and deposit to:

Traveling Aggies, The Association of Former Students
505 George Bush Drive, College Station, TX 77840
Fax: (979) 845-9263

Cabin Category	Standard Rate	Special Rate*	Cabin Category	Standard Rate	Special Rate*
Standard	\$4,399	\$3,995	Master Suite	\$6,899	\$6,495
Classic Double	\$5,399	\$4,995	Single (Standard)	\$7,399	\$6,995
Classic Twin	\$5,799	\$5,395			

Registration, Deposits and Final Payment. To confirm and secure your reservation, a deposit of \$850 per person per program, a deposit for any extension(s), and any non-refundable advanced payments, payable by check, online check/ACH, money order, wire transfer of same day U.S. funds, or major credit card, is due at the time of registration. Final payment, including any extension(s) and optional(s), is payable by check, online check/ACH, money order, or wire transfer of same day U.S. funds ONLY and due no later than 90 days prior to the scheduled program departure date. If your reservation is made fewer than 90 days prior to departure, the entire cost of the program, including any extension(s) and optional(s), is due at the time of registration by check, money order, or wire transfer of same day U.S. funds ONLY. If final payment is not received by Orbridge at least 90 days prior to the scheduled program departure date, Orbridge may, at any time and with or without notice, cancel your reservation in its sole discretion with no right of refund. All payments we receive from you are herein defined as "Payments." CST#2098750-40 WST#602828994

Cancellations and Refunds. All cancellations must be submitted to Orbridge in writing and will be subject to a cancellation fee ("Cancellation Fee") as follows: (a) if the cancellation notice is received by Orbridge 151 or more days prior to the scheduled departure date, the cancellation fee will be \$500 per person per program, \$300 per person per extension, and any non-refundable advance payment(s); (b) if the cancellation notice is received by Orbridge between 150 and 91 days prior to the scheduled departure date the cancellation fee will be forfeiture of the full deposit per person per program including any extension(s) and non-refundable payment(s); (c) if the cancellation notice is received by Orbridge 90 or fewer days prior to the scheduled departure date, the cancellation fee will be the full program price, including any extension(s) and non-refundable payments. In addition to and not in lieu of the foregoing, a Cancellation Fee equal to 100% of the carrier charge applies to all non-refundable airfares due to your cancellation made at any time prior to the scheduled program departure date, as applicable. Refunds, if any, of any Payments in excess of the aggregate Cancellation Fee shall be processed within 30 calendar days of our receipt of your written notice.

For complete Terms & Conditions, visit <http://terms.orbridge.com> | Copyright © 2016 Orbridge, LLC | www.orbridge.com | (866) 639-0079

*Special group rate; limited offer. Rates are per person, based on double occupancy except where noted as Single, in U.S. dollars. Single availability limited. Internal airfare between the mainland and the Galapagos Islands is included; airfare otherwise not included. Extension rate includes internal airfare between Lima and Cusco on days 9 & 13; airfare otherwise not included. Airfare from main program (Guayaquil) to extension (Lima), will be charged additionally at \$690 per person. Machu Picchu Deluxe Category includes room upgrades at the following properties: Inkaterra Machu Picchu Pueblo Hotel, Aranwa Boutique Hotel – Cusco, and Casa Andina Select Miraflores – Lima. Upgrade availability is limited. **A complement to the educational component of this journey, Expedition Libraries are curated collections of useful resources and background reading tailored to this program. Place your deposit on or before the specified date, and one Expedition Library per room will be sent upon receipt of final payment. Libraries may be purchased; please call for details.



The Association
OF FORMER STUDENTS®

TEXAS A&M UNIVERSITY®

Traveling Aggies

What Guests Are Saying...

I will only travel on cruises with the Traveling Aggies from now on!

~Allen '82 and Lynne '85 Mabry

We will forever cherish our amazing memory of trips taken with The Traveling Aggies, as well as wonderful new friendships we have made! Now, whenever we travel on 'non-Aggie' trips, we realize nothing can compare!
~Randy '74 and Gail Parker

This was the trip of a lifetime. Wildlife viewing, snorkeling, kayaking, hiking and to top it off, excellent food, top notch Naturalists, small group camaraderie and a chance to get away from it all!

~Rebecca Smith '80

The Galapagos Islands

FEBRUARY 22 - MARCH 1, 2017

Special Former Student Rate: **Save more than \$800**
per couple

Traveling Aggies
The Association of Former Students
505 George Bush Drive
College Station, TX 77840

PRSR STD
U.S. POSTAGE
PAID
PERMIT NO. 825
SAN DIEGO, CA

FREE ORBRIDGE 
EXPEDITION LIBRARY

When you reserve
by July 11, 2016**